

Series 535 combined PRV and cold fill 2 part manifold assembly

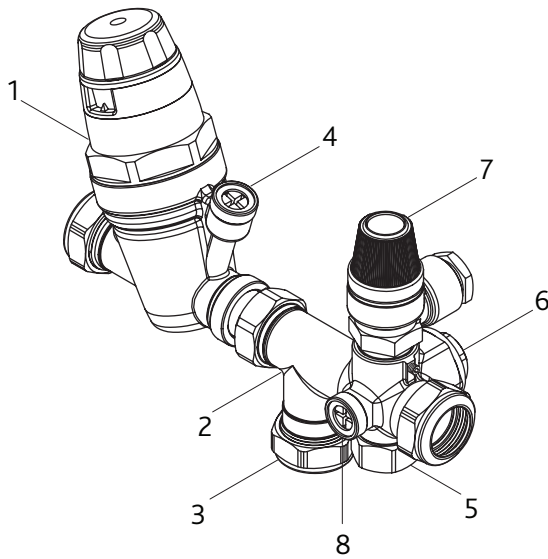

Item	Component
1	Pressure Reducing Valve
2	Manifold Assembly
3	22mm Balanced Take Off
4	Pressure Gauge Connection
5	Connection for Vessel
6	3/4" Connection for Vessel
7	Safety Relief Valve
8	Gauge - PT Point

Max. working temperature: 40°C
Max. working pressure: 10 bar

Function

Pressure reducing valves (PRV) are installed in domestic water systems to reduce and stabilise the inlet pressure from the mains supply, which is generally too high and variable for domestic appliances to function properly.

Description

The unit comprises of two parts, a pressure reducing valve and a manifold containing a check valve, a cold water balancing port and a preset pressure relief valve.

They can be fitted together or as separate units, either horizontally or vertically with the PRV always first in line.

Installation

Carefully follow these instructions and ensure that the installation conforms to the Regulations.

Ensure that sufficient water pressure and flow rate are available.

Open fully all taps before installing the unit to flush the system and expel any air remaining in the pipes.

It is recommended that isolating valves are installed upstream and downstream to facilitate any future maintenance.

A 'Y' strainer or filter should be installed upstream to prevent debris from entering the unit, which may affect its performance.

Install the PRV with the embossed arrow pointing in the direction of flow and the manifold with the 3/4" male thread as the inlet.

The black plug is a connection for a pressure gauge, which is available when specified.

Firstly, loosen the Allen Key screw and rotate the pressure relief valve to the required position.

Ensure the safety valve is seated correctly then re-tighten the Allen Key screw until fully tightened.

Ensure that the pressure relief valve discharge pipework has a continuous fall and terminates in such a position as not to cause injury.

The connection on the manifold contains a check valve and may be used as a balanced cold water supply. If not used fit the blanking piece supplied with the unit.

The connection on the manifold is used when an expansion vessel is required or may be used for a drain off. If not used fit the blanking piece supplied with the unit.

On the opposite side of the manifold to the pressure gauge connection, there is a plugged connection that may also be used for direct mounting to an expansion vessel if required.

Series 535 combined PRV and cold fill 2 part manifold assembly

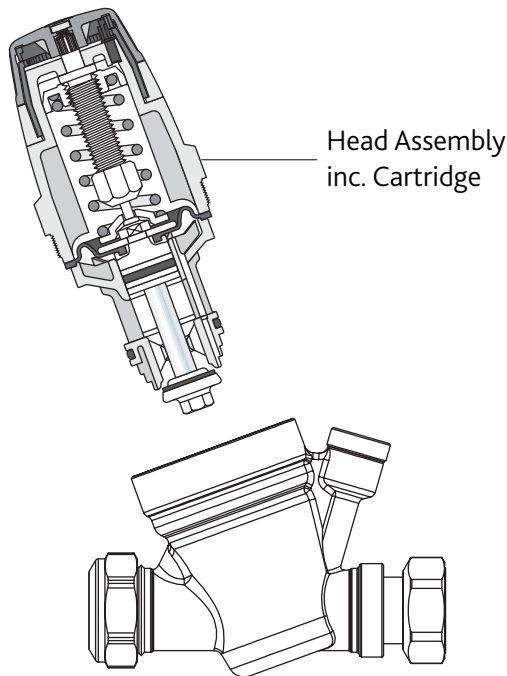

Setting the Pressure

The head assembly contains the pressure regulating cartridge which is factory calibrated.

The valve can be set at the required pressure prior to installation by means of the adjustment knob with pressure setting indicator, the numbers representing the outlet pressure in bar.

The valve can be fitted with a pressure gauge if confirmation of the outlet pressure is required.

Maintenance and Servicing

Under normal circumstances the unit should not require any maintenance, but regular inspection and cleaning the upstream filter (if fitted) is recommended.

If the pressure reducing valve fails to work correctly the head assembly containing the cartridge must be replaced.

Isolate the water supply to the pressure reducing valve.

Using a correctly fitting spanner unscrew the head assembly and replace with a new unit.

Turn on the water supply and check for leakage.

Set the pressure reducing valve to the specified outlet pressure.

NOTE:

If this is used as a replacement part on an unvented hot water storage cylinder please ensure that the pressure setting of the reducing valve and expansion relief valve match the specification of the cylinder manufacturer – incorrect installation may cause injury or damages.

Due care should be taken to ensure that all joints are water tight, however excess force may damage the plastic plug which are factory fitted to the valve body if these plugs are subjected to excess force

E & O.E

Altecnic Ltd Mustang Drive, Stafford, Staffordshire ST16 1GW

T: +44 (0)1785 218200 E: sales@altecnic.co.uk

Registered in England No: 2095101

altecnic.co.uk

IOM 009 16-10-14

altecnic